

CITY OF SPRINGFIELD

CITY MAYOR 859-336-5441
 CITY CLERK 859-336-5440
 CITY TREASURER 859-336-5441
 ECONOMIC DEVELOPMENT 859-336-0052
 FIRE DEPARTMENT 859-336-9718
 POLICE DEPARTMENT 859-336-5450
 WASTE WATER TREATMENT PLANT 859-336-5457
 WATER COMPANY 859-336-5454
 MAIN STREET/RENAISSANCE 859-336-5412
 CITY PARK 859-336-5448
 PUBLIC WORKS 859-336-5445
 HOUSING AUTHORITY 859-336-7645

- ZONING DISTRICTS**
- SINGLE FAMILY RESIDENTIAL (R-1)
 - TWO & THREE FAMILY RESIDENTIAL (R-2)
 - MULTI-FAMILY RESIDENTIAL (R-3)
 - CENTRAL COMMERCIAL (CC)
 - RESTRICTED COMMERCIAL (CR)
 - HIGHWAY COMMERCIAL (HC)
 - INDUSTRIAL (I)
 - PLANNED UNIT DEVELOPMENT (PUD)

- LEGEND**
- CORPORATE LIMITS
 - PROPERTY LINES
 - STREETS
 - STREAMS

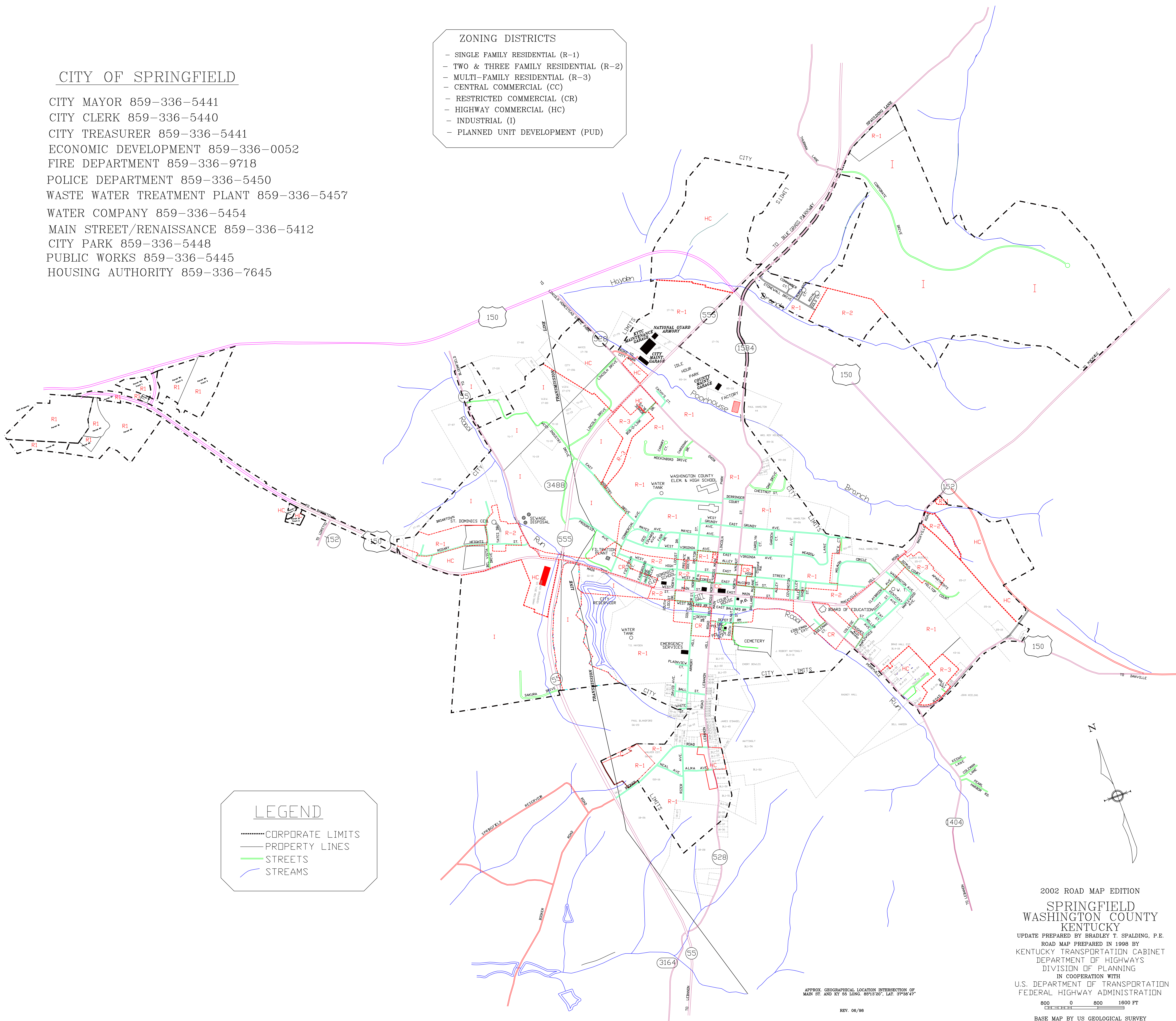

APPROX. GEOGRAPHICAL LOCATION INTERSECTION OF
 MAIN ST. AND KY 55 LONG. 89°13'20", LAT. 37°38'47"

REV. 06/98

2002 ROAD MAP EDITION
SPRINGFIELD
WASHINGTON COUNTY
KENTUCKY
 UPDATE PREPARED BY BRADLEY T. SPALDING, P.E.
 ROAD MAP PREPARED IN 1998 BY
 KENTUCKY TRANSPORTATION CABINET
 DEPARTMENT OF HIGHWAYS
 DIVISION OF PLANNING
 IN COOPERATION WITH
 U.S. DEPARTMENT OF TRANSPORTATION
 FEDERAL HIGHWAY ADMINISTRATION
 800 0 800 1600 FT
 BASE MAP BY US GEOLOGICAL SURVEY